

## PROJECT OUTLINE 2004 - Gresham Oregon Light Rail Station Area Development

Client: TOD ( Transit Oriented Development ) Department of METRO - A Regional Planning Authority - Portland, Oregon  
<http://www.metro-region.org/>

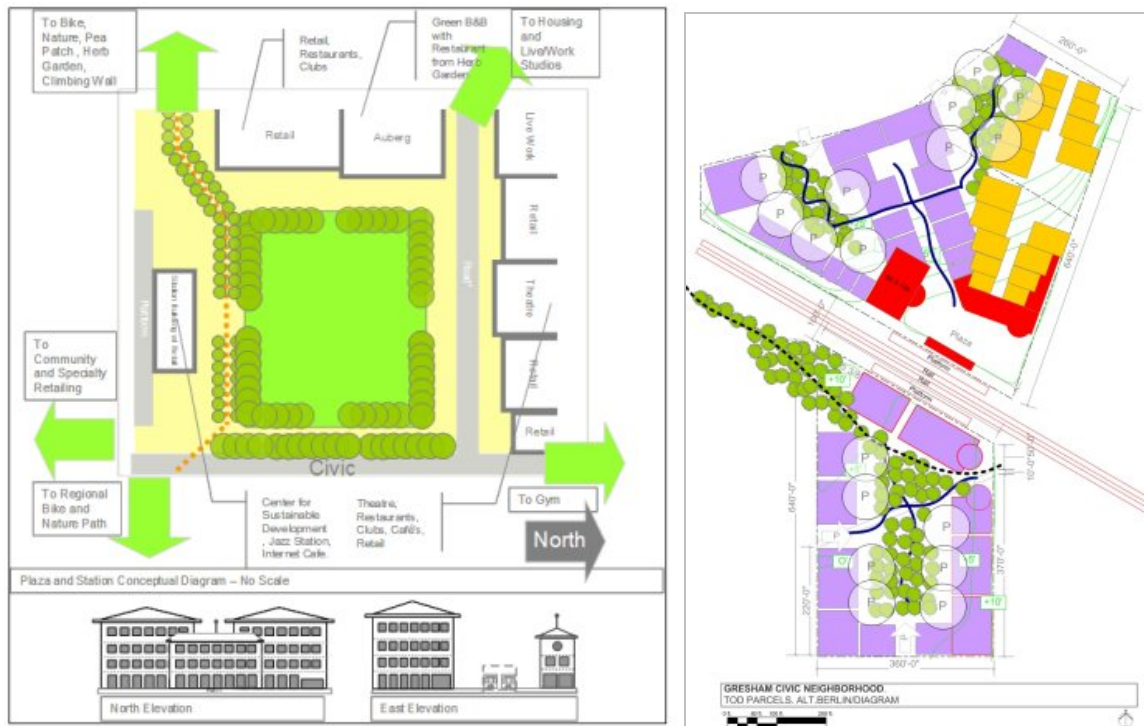

### Background:

As part of a public-private partnership with City of Gresham, TriMet and private developers, Metro's Transit Oriented Development (TOD) Program's role is to use joint development tools to ensure that land they control is developed in transit-supportive ways.

TOD controls three sites adjacent to a future light rail station in Gresham Oregon. These sites are located within Gresham Civic Neighborhood which is supported by Gresham policy and code designed to induce higher density development surrounding the new Gresham Light Rail Station. TOD's goal is for the Gresham Light Rail transit station to be a focal point for the development of a regional showcase for transit joint development and sustainable development.

### Objectives:

MAKINA was responsible for recommending a development program to utilize the TOD project sites and transit station in such a way as to promote market feasible patterns of sustainable development.

MAKINA managed an interdisciplinary team of architects, urban designers, market analysts, sustainable development consultants and artists to explore alternative visions and strategies in order to inform its recommendations.

### Primary Recommendations

- Alternative and recommended development program mixes for retail, commercial and residential uses supporting - market feasible - transit and sustainable development principles.
- Supporting site plans for land parcels, Station Areas and Public Open Space.

### Contact

For more information:

Paul Reinhart [paul.reinhart@makina.us](mailto:paul.reinhart@makina.us) 206.850.3955